

Fence Requirements

HOW TO USE THIS GUIDE

At least two complete documents must be provided to apply for a permit.

- 1) **Complete this guide**-By filling in the blanks on page 3 and indicating which type of construction will be used.
- 2) **Provide a site plan**-Showing dimension of your project and its relationship to existing property lines and structures on the property.
- 3) **Fill out a building permit application**-The majority of permit applications are processed with little delay. The submitted documents will help determine if the project is in compliance with building codes, zoning ordinances and other applicable laws.

Fences, hedges, and walls may be permitted in the required yard area in any district subject to the following conditions and requirements:

- 1) All fences and walls are subject to the applicable section of the building code.
- 2) No fence, hedge or wall may extend beyond or across a property line unless with the joint agreement of the abutting property owner. It shall be the responsibility of the property owner to locate all property lines.
- 3) No fence, hedge or wall shall be placed nearer than twelve (12) inches from a public sidewalk.
- 4) No barbed wire, sharp-pointed or electrically charged fence shall be permitted, with the exception that in the industrial (IN) zone only, up to three (3) strands of barbed wire may be attached to the top of a minimum six (6) foot high fence for security purposes.
- 5) Fences located within the required front yard setback shall not exceed four (4) feet in height. In addition, on corner lots any obstruction of any nature whatsoever over thirty (30) inches in height shall not be allowed within the sight triangle established for the adjacent intersection except for trees with branches and foliage removed to a height of seven (7) feet above the ground and open wire fencing that does not obscure vision more than ten (10%). Said sight triangle shall be determined in accordance with local ordinances.

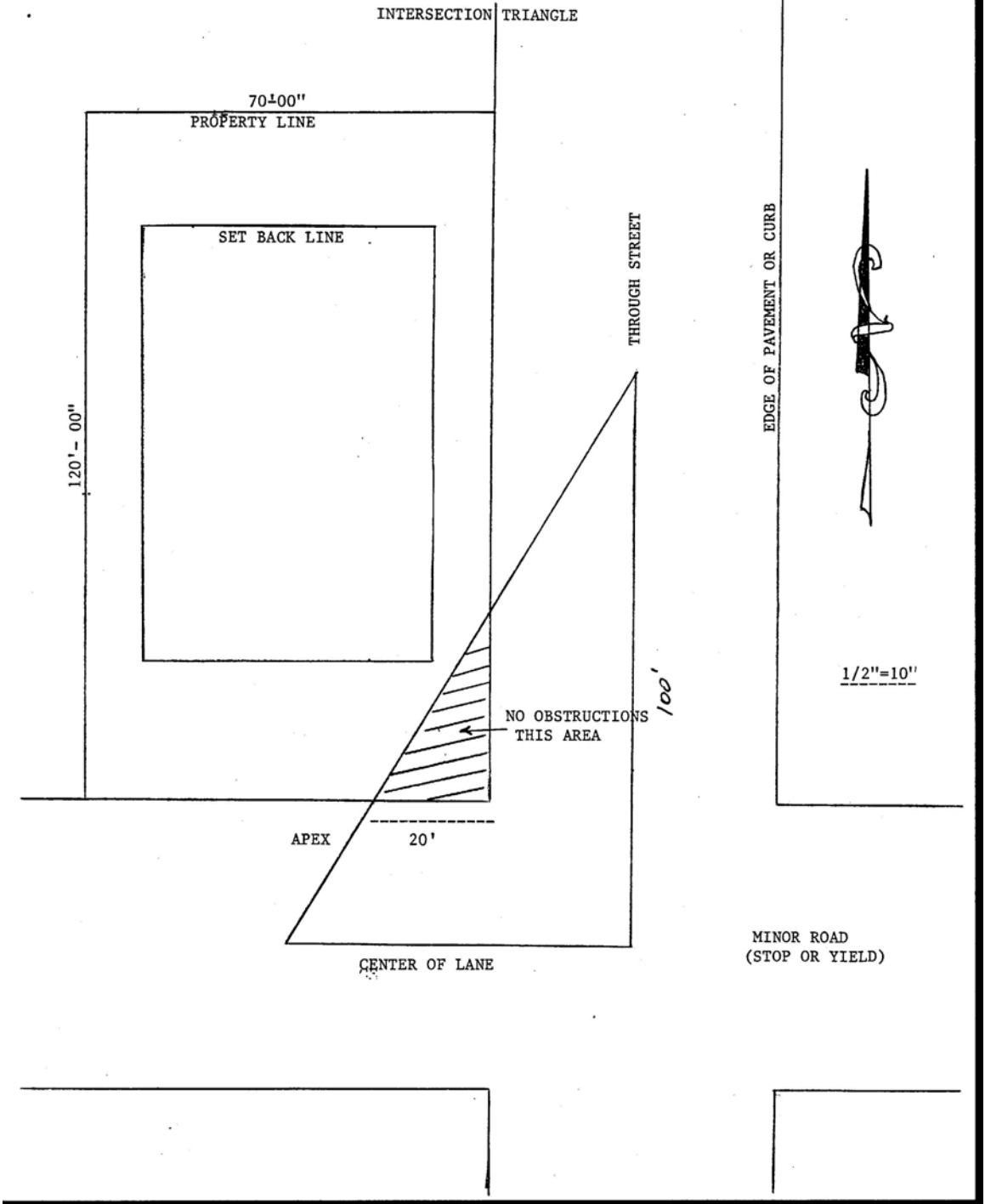

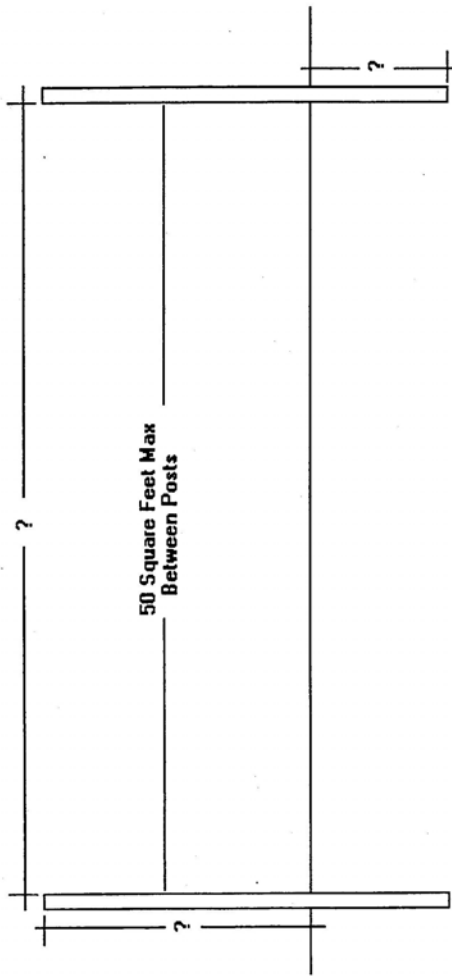

- 1) Post Depth (The Amount Of Post In The Ground) _____
- 2) Fence Height _____
- 3) Spacing Between Posts _____
- 4) Type Of Fence _____